

RAM® Mount

Tough-Box™ Console Faceplate Sizing & Assembly Instructions

| | | | |
|----------------|-------|--------|--|
| Name | | | |
| Phone # | | | |
| e-mail | | | |
| Sales Rep. | | | |
| Contact me by: | Phone | e-mail | |

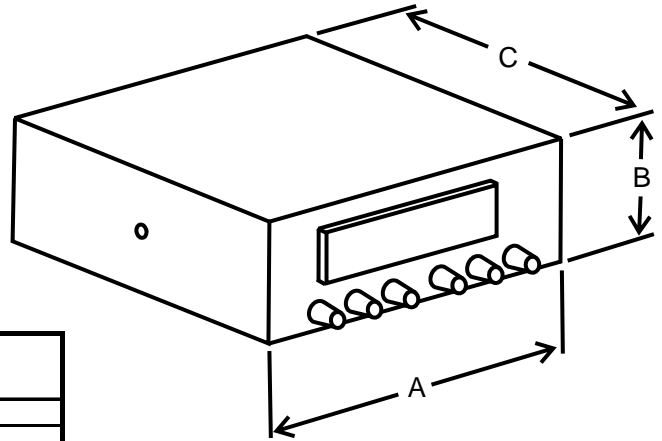

| Important Note: RAM Faceplate Part # Example: RAM-FP3-5125-2250 | | | |
|--|--------------------|---|---|
| RAM | FP3 | 5125 | 2250 |
| RAM Mount Identifier | 3" Faceplate Blank | A Dimension of opening will be 5.125" plus .080" for clearance, actual dimension will be 5.205" | B Dimension of opening will be 2.250" plus .080" for clearance, actual dimension will be 5.330" |

| Faceplate Code #1 | | Faceplate Code #2 | | Faceplate Code #3 | |
|------------------------|--|------------------------|--|------------------------|--|
| Equipment Manufacturer | | Equipment Manufacturer | | Equipment Manufacturer | |
| Manufacturer Model # | | Manufacturer Model # | | Manufacturer Model # | |
| Equipment Dimensions | | Equipment Dimensions | | Equipment Dimensions | |
| A | | A | | A | |
| B | | B | | B | |
| C | | C | | C | |

| Faceplate Code #4 | | Faceplate Code #5 | | Faceplate Code #6 | |
|------------------------|--|------------------------|--|------------------------|--|
| Equipment Manufacturer | | Equipment Manufacturer | | Equipment Manufacturer | |
| Manufacturer Model # | | Manufacturer Model # | | Manufacturer Model # | |
| Equipment Dimensions | | Equipment Dimensions | | Equipment Dimensions | |
| A | | A | | A | |
| B | | B | | B | |
| C | | C | | C | |

National Products Inc. 8410 Dallas Ave. S. Seattle, WA 98108

Phone: (206) 763-8361 Fax: (206) 763-9615

Web: www.ram-mount.com E-mail: staff@ram-mount.com

#RMR-INS-FP

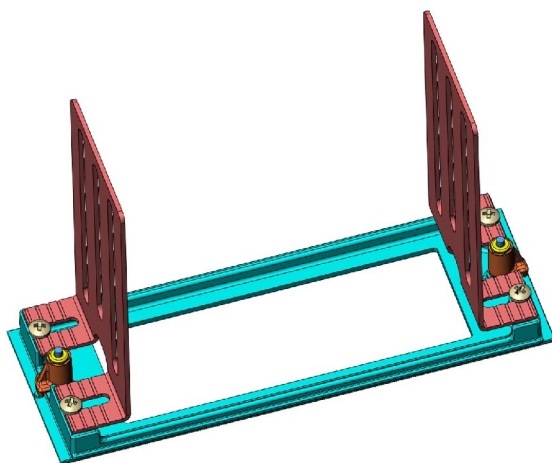
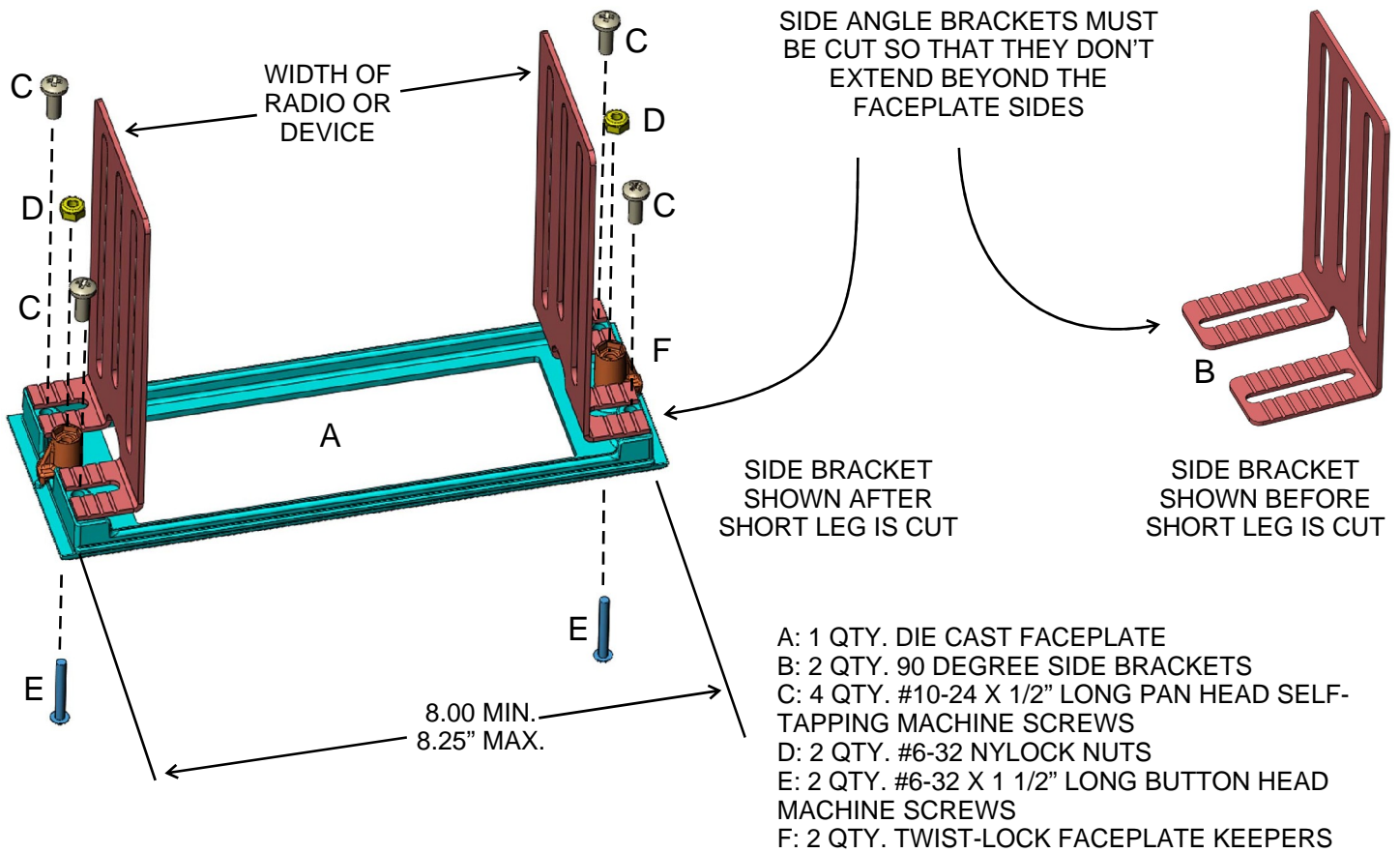

FACEPLATE ASSEMBLY PRIOR TO INSTALLING RADIO OR EQUIPMENT. WE SUGGEST CHECKING THAT THIS ASSEMBLY WILL FIT INTO THE TOUGH-BOX CONSOLE PRIOR TO ATTACHING THE RADIO OR EQUIPMENT JUST TO MAKE CERTAIN THE SIDE BRACKETS ARE CUT PROPERLY.

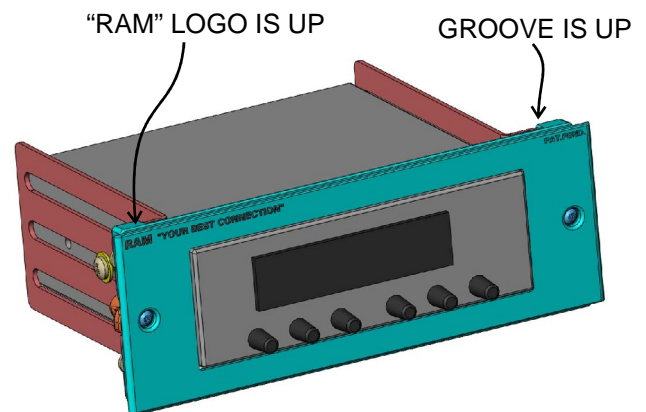

IMPORTANT NOTE: THE FACEPLATE HAS A TONGUE AND GROOVE DESIGN AND THEY MUST BE ORIENTATED PROPERLY WITH THE RADIO. THE GROOVE MUST BE UP, THE EASIEST WAY TO IDENTIFY THE UP ORIENTATION OF THE FACEPLATE IS TO LOOK AT THE "RAM" LOGO ON THE FRONT OF THE FACEPLATE. THIS LETTERING IS TO BE UP WHEN ORIENTATING THE RADIO OR EQUIPMENT OR IT WON'T PROPERLY FIT INTO THE TOUGH-BOX

PATENTED & PATENTS PENDING

National Products Inc. 8410 Dallas Ave. S. Seattle, WA 98108

Phone: (206) 763-8361 Fax: (206) 763-9615

Web: www.ram-mount.com E-mail: staff@ram-mount.com

#RMR-INS-FP

This document was created with Win2PDF available at <http://www.win2pdf.com>.
The unregistered version of Win2PDF is for evaluation or non-commercial use only.
This page will not be added after purchasing Win2PDF.